



ADA County Residential Listing Report

General Information

Parcel #: R8220270040
Sub Division/Addition: SUMMERSKY COVE SUB

Primary Owner: LIBERTY PARTNERS INC
Secondary Owner:
Physical Address: 1026 N GRAY CLOUD WAY
 MERIDIAN, ID 83642-0000
Mailing Address: 4190 N STAR RD
 MERIDIAN, ID 83646-5302
Legal Description: LOT 04 BLK 01 SUMMERSKY COVE SUB

Total Acreage: 0.174
Zoning: R-15
Land Use:

Primary Characteristic: LAND
School District: MERIDIAN SCHOOL DISTRICT
 Chaparral
Twn-Rng-Sec 3N1W11
Neighborhood:
Irrigation District: NAMPA-MERIDIAN IRRIGATION DISTRICT &
 DRAINAGE
Fire District: Meridian Fire District
Soils: SICL SIL
Flood Zone: X
MLS Area: NW Meridian: 1030



Tax & Financial Information:

Year:	Assd Val:	HO Exmpt:	Tax Val:	Est Tax:
2008	\$64,200.00	\$0.00	\$60,000.00	\$571.63
2007	\$60,000.00	\$0.00	\$60,000.00	\$571.63
---	---	---	---	---
---	---	---	---	---
Last Published Levy:			0.009527174	
Code Area:			242	
150: Rural Residential Subdivisions			\$64,200.00	

Residential Characteristics

Year Built:	Low Flr SqFt Fin:	Deck 1 SqFt:
Property Type:	Low Flr SqFt Un-Fin:	Deck 1 Covered?:
Design:	Basement SqFt Fin:	Deck 2 SqFt:
No. Bedrooms:	Basement SqFt Un-Fin:	Deck 2 Covered?:
No. Bathrooms:	Attic SqFt Fin:	Patio 1 SqFt:
No. Kitchens:	Attic SqFt Un-Fin:	Patio 1 Covered?:
No. Fireplaces:	Car 1 Storage SqFt:	Patio 2 SqFt:
Heating Method?:	Car 1 Storage Type:	Patio 2 Covered?:
Air Conditioning?:	Car 2 Storage Type:	Pool SqFt:
Ground Floor SqFt:	Car 2 Storage SqFt:	Gen. Purpose Bldg SqFt:
Upper Floor SqFt:	Porch SqFt:	

Total SqFt:
\$/SqFt



ADA County Residential Listing Report

General Information

Parcel #: R8220270030
Sub Division/Addition: SUMMERSKY COVE SUB

Primary Owner: LIBERTY PARTNERS INC
Secondary Owner:
Physical Address: 1058 N GRAY CLOUD WAY
 MERIDIAN, ID 83642-0000
Mailing Address: 4190 N STAR RD
 MERIDIAN, ID 83646-5302
Legal Description: LOT 03 BLK 01 SUMMERSKY COVE SUB

Total Acreage: 0.146
Zoning: R-15
Land Use:

Primary Characteristic: LAND
School District: MERIDIAN SCHOOL DISTRICT
 Chaparral
Twn-Rng-Sec 3N1W11
Neighborhood:
Irrigation District: NAMPA-MERIDIAN IRRIGATION DISTRICT &
 DRAINAGE
Fire District: Meridian Fire District
Soils: SICL SIL
Flood Zone: X
MLS Area: NW Meridian: 1030



Tax & Financial Information:

Year:	Assd Val:	HO Exmpt:	Tax Val:	Est Tax:
2008	\$64,200.00	\$0.00	\$60,000.00	\$571.63
2007	\$60,000.00	\$0.00	\$60,000.00	\$571.63
---	---	---	---	---
---	---	---	---	---

Last Published Levy: 0.009527174
Code Area: 242
 150: Rural Residential Subdivisions \$64,200.00

Residential Characteristics

Year Built:	Low Flr SqFt Fin:	Deck 1 SqFt:
Property Type:	Low Flr SqFt Un-Fin:	Deck 1 Covered?:
Design:	Basement SqFt Fin:	Deck 2 SqFt:
No. Bedrooms:	Basement SqFt Un-Fin:	Deck 2 Covered?:
No. Bathrooms:	Attic SqFt Fin:	Patio 1 SqFt:
No. Kitchens:	Attic SqFt Un-Fin:	Patio 1 Covered?:
No. Fireplaces:	Car 1 Storage SqFt:	Patio 2 SqFt:
Heating Method?:	Car 1 Storage Type:	Patio 2 Covered?:
Air Conditioning?:	Car 2 Storage Type:	Pool SqFt:
Ground Floor SqFt:	Car 2 Storage SqFt:	Gen. Purpose Bldg SqFt:
Upper Floor SqFt:	Porch SqFt:	

Total SqFt:
\$/SqFt



ADA County Residential Listing Report

General Information

Parcel #: R8220270020
Sub Division/Addition: SUMMERSKY COVE SUB

Primary Owner: LIBERTY PARTNERS INC
Secondary Owner:
Physical Address: 1090 N GRAY CLOUD WAY
 MERIDIAN, ID 83642-0000
Mailing Address: 4190 N STAR RD
 MERIDIAN, ID 83646-5302
Legal Description: LOT 02 BLK 01 SUMMERSKY COVE SUB



Total Acreage: 0.131
Zoning: R-15
Land Use:
Primary Characteristic: LAND
School District: MERIDIAN SCHOOL DISTRICT
 Chaparral
Twn-Rng-Sec 3N1W11
Neighborhood:
Irrigation District: NAMPA-MERIDIAN IRRIGATION DISTRICT &
 DRAINAGE
Fire District: Meridian Fire District
Soils: SICL SIL
Flood Zone: X
MLS Area: NW Meridian: 1030

Tax & Financial Information:

Year:	Assd Val:	HO Exmpt:	Tax Val:	Est Tax:
2008	\$64,200.00	\$0.00	\$60,000.00	\$571.63
2007	\$60,000.00	\$0.00	\$60,000.00	\$571.63
---	---	---	---	---
---	---	---	---	---
Last Published Levy:			0.009527174	
Code Area:			242	
150: Rural Residential Subdivisions			\$64,200.00	

Residential Characteristics

Year Built:	Low Flr SqFt Fin:	Deck 1 SqFt:
Property Type:	Low Flr SqFt Un-Fin:	Deck 1 Covered?:
Design:	Basement SqFt Fin:	Deck 2 SqFt:
No. Bedrooms:	Basement SqFt Un-Fin:	Deck 2 Covered?:
No. Bathrooms:	Attic SqFt Fin:	Patio 1 SqFt:
No. Kitchens:	Attic SqFt Un-Fin:	Patio 1 Covered?:
No. Fireplaces:	Car 1 Storage SqFt:	Patio 2 SqFt:
Heating Method?:	Car 1 Storage Type:	Patio 2 Covered?:
Air Conditioning?:	Car 2 Storage Type:	Pool SqFt:
Ground Floor SqFt:	Car 2 Storage SqFt:	Gen. Purpose Bldg SqFt:
Upper Floor SqFt:	Porch SqFt:	

Total SqFt:
\$/SqFt



ADA County Residential Listing Report

General Information

Parcel #: R8220270010
Sub Division/Addition: SUMMERSKY COVE SUB

Primary Owner: LIBERTY PARTNERS INC
Secondary Owner:
Physical Address: 1098 N GRAY CLOUD WAY
 MERIDIAN, ID 83642-0000
Mailing Address: 4190 N STAR RD
 MERIDIAN, ID 83646-5302
Legal Description: LOT 01 BLK 01 SUMMERSKY COVE SUB

Total Acreage: 0.179
Zoning: R-15
Land Use:

Primary Characteristic: LAND
School District: MERIDIAN SCHOOL DISTRICT
 Chaparral
Twn-Rng-Sec 3N1W11
Neighborhood:
Irrigation District: NAMPA-MERIDIAN IRRIGATION DISTRICT &
 DRAINAGE
Fire District: Meridian Fire District
Soils: SICL SIL
Flood Zone: X
MLS Area: NW Meridian: 1030



Tax & Financial Information:

Year:	Assd Val:	HO Exmpt:	Tax Val:	Est Tax:
2008	\$74,900.00	\$0.00	\$70,000.00	\$666.90
2007	\$70,000.00	\$0.00	\$70,000.00	\$666.90
---	---	---	---	---
---	---	---	---	---

Last Published Levy: 0.009527174
Code Area: 242
 150: Rural Residential Subdivisions \$74,900.00

Residential Characteristics

Year Built:	Low Flr SqFt Fin:	Deck 1 SqFt:
Property Type:	Low Flr SqFt Un-Fin:	Deck 1 Covered?:
Design:	Basement SqFt Fin:	Deck 2 SqFt:
No. Bedrooms:	Basement SqFt Un-Fin:	Deck 2 Covered?:
No. Bathrooms:	Attic SqFt Fin:	Patio 1 SqFt:
No. Kitchens:	Attic SqFt Un-Fin:	Patio 1 Covered?:
No. Fireplaces:	Car 1 Storage SqFt:	Patio 2 SqFt:
Heating Method?:	Car 1 Storage Type:	Patio 2 Covered?:
Air Conditioning?:	Car 2 Storage Type:	Pool SqFt:
Ground Floor SqFt:	Car 2 Storage SqFt:	Gen. Purpose Bldg SqFt:
Upper Floor SqFt:	Porch SqFt:	

Total SqFt:
\$/SqFt

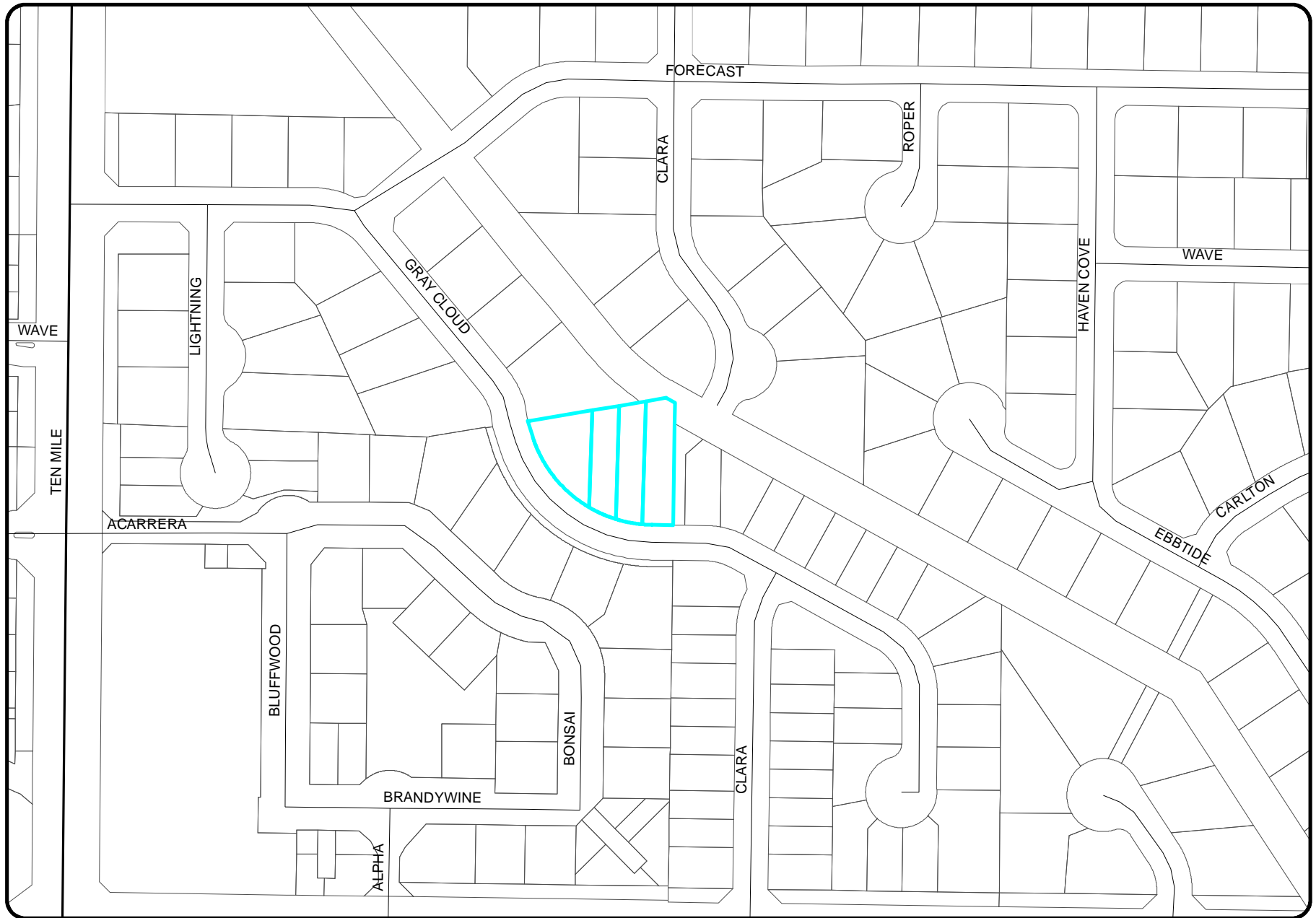

This Map and data displayed is a graphic representation derived from the Ada County Geographic Information System (GIS) data. It was designed and intended for staff use only. It is not guaranteed survey accuracy.

This map is based on information available and was compiled from numerous sources which may not be accurate. Users are to field verify this information. Ada County and Single Point Solutions, Inc are not liable for errors or omissions resulting from the use of this product for any purpose.

