

# The Historic Nouque Ranch

339,230 +/- Acres Working Cattle Ranch

1,611 +/- Deeded - 337,619 +/- BLM Acres

**\*\*Ranch Equipment Selling Separately Same Day\*\***

**Court Ordered Online Only AUCTIONS**

**Ends Thursday, March 15, 2012**

**Oregon/Nevada Border - 3.5 Miles NE of McDermitt, NV**

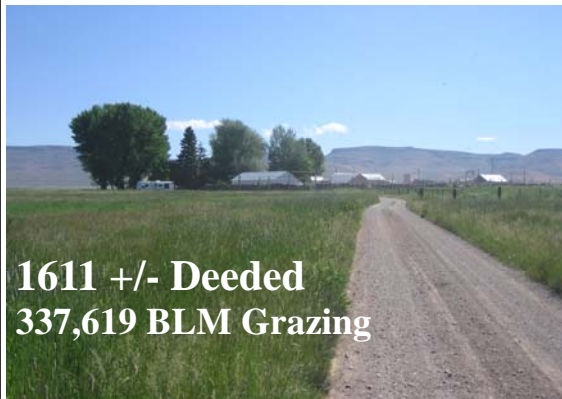

1611 +/- Deeded  
337,619 BLM Grazing



**\*\*PREVIEW EQUIPMENT \*\***

**March 6th 11-5pm & March 7th 8-3pm**

**RANCH:** A unique & historic ranch founded by the Nouque ("new kay") family in the late 1800's. 1,611.65 +/- Deeded Acres, 620 +/- Irrigated Hay Meadows, 337,619 Public Grazing Land with 4,197 AUM's. Productive deeded & public grazing land known for its outstanding grass production and water/springs. Headquarters includes two homes, & bunkhouse. The newer home is equipped with commercial ovens/grill/hood & walk-in freezer. Three barns, 5T cattle scale, lighted shipping and sorting corrals, historic willow corrals, two shop buildings, machine shed, water storage tank, and cabin at Deer Flat cow camp. Oregon landowner preference tags available for 3-elk, 3-antlered deer, 3-antlerless deer, & 3-antelope. Call for preliminary title reports and to schedule a tour today! All property private and public land is fenced and cross fenced. Buyer and Buyer's Agent to Verify All.

**\*\*\*Real Estate Portion of Auction Closes Thursday, March 15th at 1PM - See [www.CorbettBottles.com](http://www.CorbettBottles.com)\*\*\***

**EQUIPMENT:** Swathers: NH 1116 Speedrower 2349 hrs., NH 1112 2090 hrs.. Balers: **\*\*99** NH 595 3x4, 98 NH 585 F4L912.

Tractors: JD 4230 duals 5920 hrs., JD 4020 w/158 loader, bale forks & bucket 2254 hrs., JD 530, **\*\*Case 1370** duals 1346 hrs.

Tillage & Machinery: JD 355 14' disc, Case 12' seeder, 2-section 20' spring tooth harrow, NH 260 & 258 tandem rake, NH 260 rake, JD 3-bottom plow, Farmhand disc, JD 6' blade model 80, Rhino G84 rotary cutter, Bush Hog 70307 3 pt., V ditcher model 162F, Eversman 2SD hydraulic scraper, bale chopper wagon. Trucks: 88 350 4x4 crew cab 138k 460 custom steel bed w/atv ramps, 65 Ford dump truck, 81 Chev., 70 dual saddle tanks w/18' diamond plate flatbed, 86 F250 XL 4x4 187k 460, 64 GMC 4000 stock trk. Trailers: 96 Hillsboro tandem steel stock trlr 7x20, WW 12' 3-horse open trlr, Buhl 16' tilt bed, JD 20' feed wagon. Collectors: JD Plow Co. LTD M835, Moline plow, sickle mower, (21) horse collars & harness, JD hay wagon mdl. 963, plow. Tools: air compressor, AC welder, 5K generator.

**\*\*\*Equipment Portion of Auction Closes Thursday, March 15th at 3PM - See [www.CorbettBottles.com](http://www.CorbettBottles.com)\*\*\***

**[www.CorbettBottles.com](http://www.CorbettBottles.com)**

Online Bidding Powered By: **proxibid**

**\*\*PREVIEW EQUIPMENT March 6th 11-5pm & March 7th 8-3pm\*\*** see website for online bidding and more descriptions/photos:

**TERMS: Real Estate:** A 5% Buyers premium will be added to final live bid price to arrive at the total purchase price. A deposit of \$100,000 must be received by Corbett Bottles Real Estate Auctions, before online bidding approval will be granted to bid on the real estate. The successful bidders deposit will be applied to the purchase price, and become non-refundable at the conclusion of the auction, all other deposits will be refunded within five business days. Balance within 30 days at closing. Property sold with no contingencies. Please inspect/conduct all due diligence prior to auction. Court approved auction with final approval by Judge 21 days after auction. Corbett Bottles Real Estate Auctions, LLC, represent the seller only. Brokers/Agents invited. All measurements approximate please verify. **PERSONAL PROPERTY TERMS:** A 5% Buyers Premium will be added to the final live bid, Cash, Check, wire, additional 3% fee for credit cards. No equipment to be removed until funds received by auction company. All sold "As-Is". See Website for further details/information. Please call/email for title reports and more information. See website for full details and registration.

**APPROVED BY:** the United States Bankruptcy Court for the District of Idaho Case No. 09-01797-JDP - Final Court Approval 21 Days After Auction. Forrest P. Hymas Chapter 12 Trustee. **Two (2) Items with Lienholder Reserve Per Trustee \*\* (\*\*99 NH 595 3x4, & \*\*Case 1370 duals 1346 hrs.)**



**The Historic Nouque Ranch**  
**339,230 +/- Acres Working Cattle Ranch**  
**& Equipment Court Ordered Online Only**  
**AUCTION**

**Both Auctions End Thursday, March 15, 2012**

**[www.CorbettBottles.com](http://www.CorbettBottles.com)**

